



## WE RECOMMEND

1. The tent is based on the scissor system. Be cautious while folding and unfolding the frame.
2. You need at least 2 people for assembly/disassembly of the tent. Tents with eight legs should be assembled/disassembled by 4 people.
3. Before disassembling the structure, it must be thoroughly cleaned. Mitko Sp. z o.o. (hereinafter referred to as the Manufacturer) is not liable for any damage resulting from multiple assembly/disassembly of the dirty structure.
4. The Manufacturer recommends to remove the roof each time the tent is disassembled (does not apply tents packed in Comfort transport bags).
5. The fabric (roof and sidewalls) should be cleaned and dried before packing it into transport bags. The Producer does not bear any responsibility for possible stains arisen as a result of storing wet or dirty fabric.
6. With recurring gusts of wind, anchoring should be checked systematically.

## SAFETY

1. The express tent is not intended for use during a strong wind, blizzards, hail, storms, etc.
2. The tent must not be left without any supervision.
3. The tents produced by the Mitko company are not adapted to exploitation under snow load. One should remove the snow gathering on the roof, if the layer of the snow is 2 cm or higher.
4. Water lingering on the roof should be immediately removed.
5. Manufacturer, states that polyester fabrics marked with OG/FR symbol are fire resistant and that they meet requirements of PN-EN 13501-1 norm.
6. Express tents may be used with wind up to 14 m/s (50 km/h) provided it is protected against wind gusts as described in table no. 1, 2, 3. During stronger wind, it is recommended in all cases to disassemble the tent (first remove the wall and then fold the roof). Mechanical damage resulting from failure to follow the above recommendations are not covered by the warranty.

Table 1: Ways to anchor a canopy Octa Pro 3 × 3 m, 3,5 × 3,5 m

Wind speed	Surface	Minimum weight / Anchor that meets the requirements to mount each foot	The anchor that meets the requirements for each $\nless 45^{\circ}$ stay
< 50 km/h	Concrete	15 kg	-
	Ground	Steel anchor length 26,5 cm, $\varnothing$ 10 mm *	Twisted steel anchor, length 34 cm *

Table 2: Ways to anchor a canopy Octa Pro 3 × 4,5 m, 3,5 × 5,25 m

Wind speed	Surface	Minimum weight / Anchor that meets the requirements to mount each foot	The anchor that meets the requirements for each $\nless 45^{\circ}$ stay
< 50 km/h	Concrete	32 kg	-
	Ground	2x steel anchor length 26,5 cm, $\varnothing$ 10 mm *	Twisted steel anchor, length 34 cm *

Table 3: Ways to anchor canopy Octa Pro 3 × 6 m

Wind speed	Surface	Minimum weight / Anchor that meets the requirements to mount each foot	The anchor that meets the requirements for each $\nless 45^{\circ}$ stay
< 50 km/h	Concrete	Corner legs: 15 kg; Center legs: 55 kg	-
	Ground	Steel anchor length 26,5 cm, $\varnothing$ 10 mm *	Twisted steel anchor, length 34 cm *

7. The Manufacturer declares that the statistical calculations for the Octa Pro tents in sizes 4 × 4 m, 4 × 6 m and 4 × 8 m have been carried out according to the PN-EN 13782:2015-2007 - "Temporary objects - Tents - Safety" norm (original calculations available at the Manufacturer). The tents may be used with wind up to 28 m/s (100 km/h) provided it is protected against wind gusts as described in tables no. 4, 5 and 6. During stronger wind, it is recommended in all cases to disassemble the tent (first remove the wall and then fold the roof). Mechanical damage resulting from failure to follow the above recommendations are not covered by the warranty.

---

\* Tent's standard equipment

Table 5: Ways to anchor a canopy Octa Pro 4 × 4 m

Wind speed	Surface	Minimum weight / Anchor that meets the requirements to mount each foot	The anchor that meets the requirements for each $\nless 45^\circ$ stay
< 50 km/h	Concrete	12 kg	-
	Ground	Steel anchor length 26,5 cm, $\varnothing$ 10 mm *	Twisted steel anchor, length 34 cm *
50 km/h < 100 km/h	Concrete	Segmented anchor HSA-R M6 × 65 20/10/ ***	Sleeve anchor (eyebolt closed) HLC-EC 10 × 50 ***
	Ground	Steel anchor length 26,5 cm, $\varnothing$ 10 mm *	Steel anchor length 90 cm, $\varnothing$ 18 mm; center legs (alternatively steel anchor length 45 cm, 35 × 35 × 4 mm) **

Table 6: Ways to anchor a canopy Octa Pro 4 × 6 m

Wind speed	Surface	Minimum weight / Anchor that meets the requirements to mount each foot	The anchor that meets the requirements for each $\nless 45^\circ$ stay
< 50 km/h	Concrete	32 kg	-
	Ground	2x steel anchor length 26,5 cm, $\varnothing$ 10 mm *	Twisted steel anchor, length 34 cm *
50 km/h < 100 km/h	Concrete	Segmented anchor HSA-R M6 × 65 20/10/ ***	Sleeve anchor (eyebolt closed) HLC-EC 10 × 50 ***
	Ground	2x steel anchor length 26,5 cm, $\varnothing$ 10 mm *	Steel anchor length 90 cm, $\varnothing$ 18 mm; center legs (alternatively steel anchor length 45 cm, 35 × 35 × 4 mm) **

\* Tent's standard equipment

\*\* Non-standard tent equipment accessory

\*\*\* Art. offered by Hilti (Poland) Sp. z o.o. (<https://www.hilti.pl/>)

Table 7: Ways to anchor a canopy Octa Pro 4 × 8 m

Wind speed	Surface	Minimum weight / Anchor that meets the requirements to mount each foot	The anchor that meets the requirements for each 45° stay
< 50 km/h	Concrete	Corner legs: 12 kg; Center legs: 51 kg	-
	Ground	Corner legs: Steel anchor 26,5 cm, Ø 10 mm; Center legs: 2x steel anchor 26,5 cm, Ø 10 mm *	Twisted steel anchor, length 34 cm *
50 km/h < 100 km/h	Concrete	Segmented anchor HSA-R M6 × 65 20/10/ ***	Sleeve anchor (eyebolt closed) HLC-EC 10 × 50 ***
	Ground	Corner legs: Steel anchor 26,5 cm, Ø 10 mm; Center legs: 2x steel anchor 26,5 cm, Ø 10 mm *	Corner legs: steel anchor 90 cm, Ø 18 mm; Center legs: 3x steel anchor length 90 cm, Ø 18 mm (alternatively steel anchors length 45 cm, 35 × 35 × 4 mm) **

#### ATTENTION

At wind speeds of 50 km/h < 100 km/h, the 4 × 8 m tent must be secured by placing, on middle legs, guy rope at 1 m height and anchor it at an angle of 45 degrees.

---

\* Tent's standard equipment

\*\* Non-standard tent equipment accessory

\*\*\* Art. offered by Hilti (Poland) Sp. z o.o. (<https://www.hilti.pl/>)

Figure 1: 4 × 8 m tent lines mounting

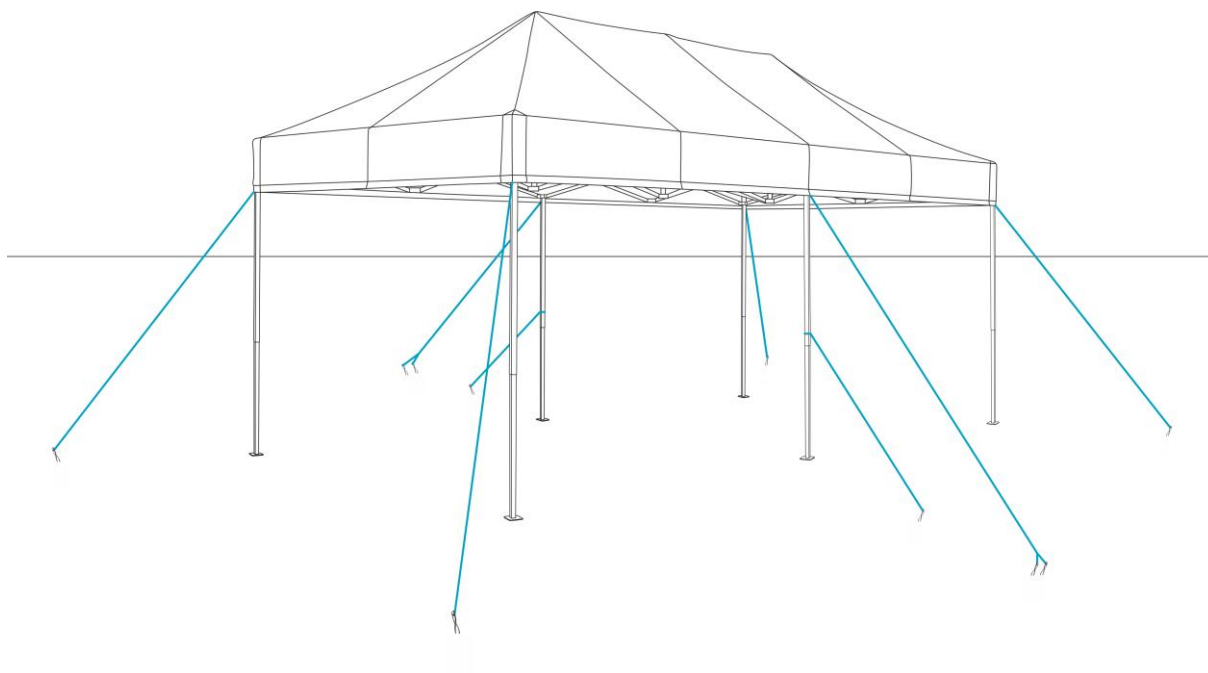

## MOUNTING PROCESS

Figure 2: Octa Pro assembly instructions

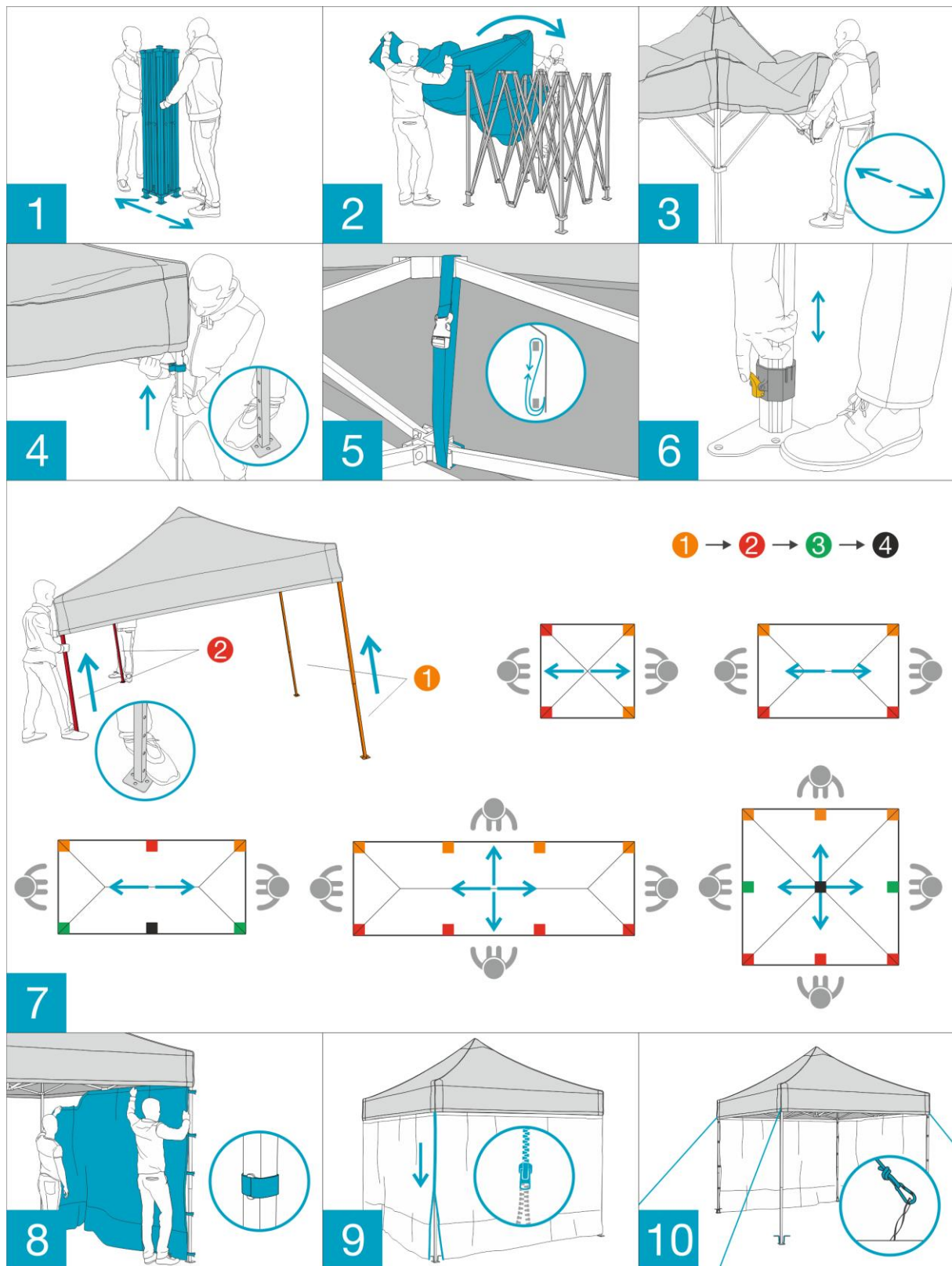

## ASSEMBLY SEQUENCE

1. Take the structure out of the case and arrange it on a level ground. Hold the legs and stretch.
2. Put the roof on. Velcro together roof and frame corners.
3. Holding the lower sabres, stretch the structure.
4. Fasten the locks in corner legs. Remember to lock the blocks on center legs. For better stability put your foot on the basis of the leg of the tent.
5. Fasten the roof with clip buckles.
6. Press the lock located on the leg, slide out the inner leg and lift the tent.  
**ATTENTION** Assemblers should lift the same side of the tent.
7. Unblock and slide out the leg on the opposite side. Depending on the tent dimensions and number of legs, please unblock and slide out the legs according to the assembly sequence.
8. Velcro the wall to the valance of the roof. Fasten wall side Velcro's around the legs.
9. Connect the walls with a zip (depending on version).
10. On the ground, secure legs of a tent with 26,5 cm long anchors. Connect one side of the guy rope, with the tent roof and anchor the other end with 34 cm twisted steel tent peg. Then stretch the guy rope at an angle of 45 degrees and anchor it. When on concrete surface, secure the tent with ballast or sleeve anchor.

## DISASSEMBLY SEQUENCE

1. First detach the walls, then detach the tent lines and remove anchors.
2. Pull out the anchors in the basis of the tent (remove the weights or remove the sleeve anchors).
3. Ensure that the base of the tent and internal legs are clean. The sand and clay accumulated on the frame can prevent the legs from sliding in. Press the lock located on the leg, slide in the inner leg and let the tent down. Note! When letting it down, the installers should be on the same side of the tent.
4. Unfasten the clip buckles.
5. Release the locks in the corner and center legs.
6. Holding the lower sabres, fold the structure.
7. Remove the lining from the structure.
8. Pack the elements of the tent into a bag.



### POLYESTER MATERIALS CARE LABEL

1. Chemical washing is forbidden.
2. Do not use a washing machine.
3. Water hand washing - try to knead softly, do not rub, do not wring.
4. Surface washing - dirty places should be washed with a sponge.
5. Washing temperature - maximum 40° C.
6. Washing detergent, intended for synthetic materials, should be used as per labelled proportions.
7. Rins 2 to 3 times in the warm water and once in the cold water.
8. Do not swirl. Do not wring.
9. Dry in the vertical position at the room temperature (allow water dripping).
10. Iron the outside of the material (uncoated) with the iron in the highest temperature of 110° C.
11. Washing with organic solvents is forbidden as well as local stains washing. It is because such materials are not resistant to solvents. Do not let big grime to appear. Do not disinfect with chlorine. Do not bleach.
12. Keep away from fire. In case of flaming up try to put the fire out with the water, dry powder or carbon dioxide extinguisher (ABC or BC).

Figure 3: Rules for polyester textiles conservation

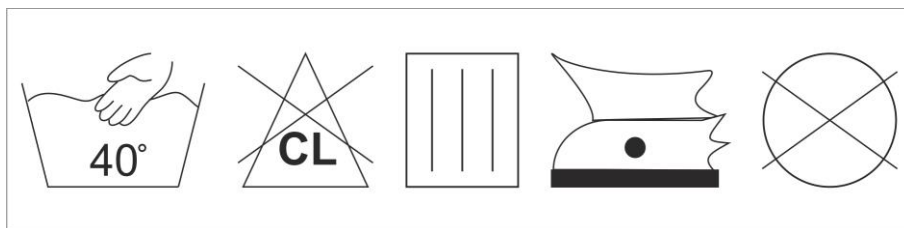

The Producer reserves the right to implement changes to above information.